



Top reasons to buy Fiery SC11

Because the investment horizon for a new digital printing system is from three to five years, it's always good to consider both current and future needs of your print environment when deciding on a new digital printing system. This document is designed to help you understand the difference in capabilities between the Fiery® servers offered for the FUJIFILM Business Innovation Revoria Press™ SC180/SC170, and how to make the right recommendation for your customer.

Fiery SC11: Exclusive features

Fiery SC11 offers exclusive features that add productivity, quality and new services to your production environment. These features are not available on Fiery SC12C.

MAXIMUM PRODUCTION PERFORMANCE

To maximise your engine capacity, you need a high-powered digital front end to process and drive data fast enough to minimise engine idle time. More robust and powerful hardware specifications make **Fiery SC11 nearly 30% faster** compared to Fiery SC12C, making it the best choice for demanding production environments.

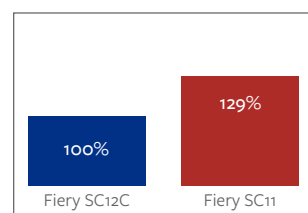

COMPLIANCE WITH KEY SECURITY STANDARDS

Fiery SC11 is validated for key customer security requirements, such as FIPS 140-2 compliant data encryption (ISO/IEC 15408 & IEEE Std 2600 (Common Criteria) compliant*). For more information, please refer to the [Fiery FS500 Pro security white paper](#).



MICROSOFT WINDOWS IOT ENTERPRISE 2019 LTSC

Fiery SC11 is built on the Microsoft Windows IoT Enterprise 2019 LTSC operating system. Plus, the server offers the option to use a customer hardened Windows OS image to meet security compliance requirements.



*With proper configuration by end customer or service provider



Fiery SC11: Exclusive features (continued)

OPTION FOR REMOVABLE DISK DRIVES

Fiery SC11 offers optional Fiery disk drive security kits, which allow the disk drives to be removed and stored in a secure location. Plus, additional disk drives are available so jobs can be segregated by security condition (such as Classified, Top Secret, Secret) if needed.

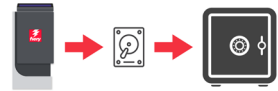

FIERY PREFLIGHT PRO

The ultimate set of PDF preflight checks, Fiery Preflight Pro (part of the optional [Fiery Graphic Arts Pro Package](#)) allows users to verify file compliance against industry standards and identify potential errors in files, which can then be viewed in the interactive Preflight Pro Report.

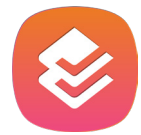

ADVANCED VDP FORMATS

Fiery SC11 supports all advanced VDP formats out-of-the-box, including PDF/VT-2, Creo® VPS®, and PPML. Plus, it works with all leading VDP composition software and formats for seamless workflows. The faster processing speed also makes offering VDP services more profitable.



FIERY QUICKTOUCH™ SOFTWARE

Fiery external servers feature the [Fiery NX Pro hardware](#). The NX Pro includes [Fiery QuickTouch](#) software on the touchscreen display, which gives faster views of job status information and access to server management. With just a tap, the touchscreen display gives operators easy access to intuitive system installation, backup and restore, plus system diagnostics.



A CENTRALISED PRODUCTION WORKSPACE FOR OPERATORS

The optional [Fiery NX Station GL](#) is a compact, centralised workstation for Fiery external servers. It features a 22" display, Fiery Ticker, work stand, and a wireless keyboard and mouse.





Fiery SC11: Standard features

Fiery SC11 includes these key features in the standard configuration. They are available for the Fiery SC12C by purchasing optional packages. Be sure to compare the cost of the Fiery SC12C with the optional packages added for a more accurate comparison to the Fiery SC11.

FULLY VISUAL IMPOSITION

[Fiery Impose](#) enables easy booklet creation, provides several gangups, supports cutting and stacking, plus integrates with offline finishers to reduce 70% of job setup time.



ADVANCED MAKEREADY

[Fiery JobMaster](#) provides advanced PDF makeready capabilities such as insertion of tab pages without the need to design them in the native application, multi-bank and bleed-edge tab setup, page merging, media assignment, finishing, page numbering, plus hard-copy scanning and cleanup. This allows you to produce jobs completely inline and reduce labour costs on manual tab insertion.



BUILT-IN PREFLIGHT

Fiery Preflight provides basic preflight checks for problems in a file. Catch issues before printing such as missing elements like spot colours or fonts, or potential errors like low-resolution images or overprint. You can automate basic preflight checks through Fiery Hot Folders or integrate with Fiery JobFlow Base/JobFlow.



SUPERIOR PHOTOGRAPHIC PRINTS

[Fiery Image Enhance Visual Editor](#), a Fiery Command WorkStation plug-in, allows operators to make last-minute edits to a selected image without having to open the image in applications such as Adobe Photoshop®.



AUTOMATE REPETITIVE MANUAL JOB SETUP

With the free [Fiery JobFlow Base](#), you can start building ready-to-use workflows today. It's a browser-based solution that automates common job types to produce ready-to-print files, significantly reducing human errors in job setup to save time, increase production capacity, and meet tight deadlines.





Both Fiery servers: Optional features

These features are available on both Fiery SC11 and Fiery SC12C by purchasing optional packages.

FIERY SPOT PRO

The most advanced tool for managing spot colours, [Fiery Spot Pro](#) ensures that brand colours are reproduced correctly, every time. With Fiery Spot Pro, users get powerful capabilities, like the ability to create a spot colour alias, import/export spot colour libraries in Adobe Swatch Exchange, create more customised swatch books, edit spot colours in L*a*b, edit spot colour tints, and edit spot colours in a specific job.



FIERY IMAGEVIEWER

With Fiery ImageViewer, the user can make more powerful late-state color edits right at the DFE. Choose to edit colours in a specific area of the page, including replacing specific colours, or adjusting the colour curves. Plus, generate customer soft proofs in just a few clicks.



ACCELERATED PRODUCTION WITH PREPRESS WORKFLOW AUTOMATION

Add [Fiery JobFlow](#) for cost-effective, advanced prepress capabilities. You can easily configure automated job workflows including PDF conversion, preflight, correction and editing of PDF files, image enhancement, document imposition, plus approval and job ticketing.



TAKE CONTROL OF COLOUR MANAGEMENT

The combination of [Fiery Color Profiler Suite](#) software with an ES-3000 spectrophotometer delivers wizard-driven calibration (including G7), profile creation, optimisation, and verification, through to expert-level profiling control, editing, and enhancement, providing market-leading tools to ensure optimal colour quality for every stage of the printing workflow.





Fiery server	Fiery SC11	Fiery SC12C
Fiery software	Fiery FS500 Pro	Fiery FS500
Fiery platform	NX Pro III	E500
CPU	Intel® Core™ i5-8500 Processor	Intel Pentium G5400 Processor
Operating system	Microsoft® Windows® 10 IoT Enterprise 2019 LTSC	Linux
RAM	8 GB (2 x 4 GB)	8 GB (2 x 4 GB)
Disk drive(s)	SSD boot drive for OS & Fiery software + 1 TB HDD	500 GB HDD
Fiery disk drive security kits	OPTIONAL	Not Available
VDP formats	PPML 2.0/2.2/3.0, PDF/VT-1, PDF/VT-2, Creo VPS, Fiery FreeForm™ Plus	PDF/VT-1, Fiery FreeForm Plus
Adobe® PDF Print Engine	INCLUDED	INCLUDED
Fiery JobExpert	INCLUDED	INCLUDED
Fiery Image Enhance Visual Editor	INCLUDED	OPTIONAL with Fiery ColorRight Package*
Fiery ImageViewer, Fiery Spot Pro, Fiery Postflight, Fiery Control Bar	OPTIONAL with Fiery Graphic Arts Pro Package*	OPTIONAL with Fiery ColorRight Package*
Fiery Preflight Pro	OPTIONAL with Fiery Graphic Arts Pro Package*	Not Available
Fiery Preflight	INCLUDED	OPTIONAL with Fiery Automation Package*
Fiery JDF	INCLUDED	INCLUDED
Fiery JobFlow Base	FREE	OPTIONAL with Fiery Automation Package*
Fiery JobFlow*	OPTIONAL	OPTIONAL with Fiery Automation Package*
Fiery Impose*	INCLUDED	OPTIONAL
Fiery Compose	OPTIONAL	OPTIONAL
Fiery JobMaster*,***	INCLUDED (5-year subscription)	OPTIONAL
Fiery Graphic Arts Pro Package*,***	OPTIONAL	Not Available
Fiery JobExpert and PDF Processing Kit	All features in kit are included	INCLUDED
Fiery ColorRight Package*,***	Not Available	OPTIONAL
Fiery Automation Package*,***	Not Available	OPTIONAL
Fiery Color Profiler Suite **	OPTIONAL	OPTIONAL
ES-3000 spectrophotometer	OPTIONAL	OPTIONAL
Fiery NX Station GL	OPTIONAL	Not Available
Fiery FreeForm Create	INCLUDED	INCLUDED
Fiery Edge factory profiles	INCLUDED	INCLUDED
Fiery Spot-On™	INCLUDED	INCLUDED
For more information on all of the features, please visit www.fiery.com		

* Free 30-day trial available

** Free trial in demo mode available

*** Available as a 5-year subscription

FUJIFILM Corporation
Authorized Distributor

global.fujifilm.com



6453 Kaiser Drive
Fremont, CA 94555

www.fiery.com

The product specifications, appearance and other details in this brochure are subject to change without notice for improvements.

Trademarks •FUJIFILM and FUJIFILM logo are registered trademarks or trademarks of FUJIFILM Corporation. •Revoria, Revoria logo and Revoria Press are registered trademarks or trademarks of FUJIFILM Business Innovation Corp.

Nothing herein should be construed as a warranty in addition to the express warranty statement provided with Fiery, LLC products and services. ColorGuard, ColorRight, Command WorkStation, ColorWise, Fiery, the Fiery logo, Fiery Compose, Fiery Driven, the Fiery Driven logo, Fiery Edge, Fiery Essential, Fiery HyperRIP, Fiery Impose, Fiery Impress, Fiery ImageViewer, Fiery Intensify, Fiery JobExpert, Fiery JobFlow, Fiery JobMaster, Fiery Prep-it, Fiery Prints, the Fiery Prints logo, Fiery TrueBrand, FreeForm, MicroPress, IQ, PrintMe, RIPChips, RIP-While-Print, Spot-On, Spot Pro, and WebTools are trademarks or registered trademarks of Fiery, LLC and/or its wholly owned subsidiaries in the U.S. and/or certain other countries. All other terms and product names may be trademarks or registered trademarks of their respective owners and are hereby acknowledged.

© 2023 FIERY, LLC. ALL RIGHTS RESERVED.