



# Top reasons to buy the Xerox EX C9065/C9070 Print Server v2.0

Because the investment horizon for a new digital printing system is from three to five years, it's always good to consider both current and future needs of your print environment when deciding on a new digital printing system. This document is designed to help you understand the difference in capabilities between the Fiery® servers offered for the Xerox® PrimeLink® C9065/C9070 Printer, and how to make the right recommendation for your customer.

## Overview

For customers that want to save money by keeping print work in-house, or who want to expand print-for-pay or in-plant services, there are two Fiery server options that can fit their needs: the Xerox EX C9065/C9070 Print Server Powered by Fiery v2.0, and the Xerox EX-i C9065/C9070 Print Server Powered by Fiery v2.0.



Xerox EX C9065/C9070  
Print Server



[Xerox PrimeLink C9065/C9070 Printer](#)



Xerox EX-i C9065/C9070  
Print Server

*Note: the Xerox EX-c C9065/C9070 Print Server is not included in this comparison, as it is targeted for basic office/workplace printing.*

## Target markets

The two servers are ideally suited for the following market segments.

- **Xerox EX-i C9060/C9070 Print Server:** Marketing departments, creative agencies, brand owners, professional services (engineering, legal, etc.), print-for-pay, in-plants, real estate, higher ed, franchisees, major accounts, and more.
- **Xerox EX C9060/C9070 Print Server:** Graphic communications, print-for-pay, franchisees, in-plants, major accounts, and more.





## Xerox EX C9065/C9070 Print Server v2.0: Exclusive features

The Xerox EX C9065/C9070 Print Server offers exclusive features that add productivity, quality and new services to your production environment. These features are not available on the EX-i C9065/C9070 Print Server.

### 1. MAXIMUM PRODUCTION PERFORMANCE

To maximise your engine capacity, you need a high-powered digital front end to process and drive data fast enough to minimise engine idle time. More robust and powerful hardware specifications make the EX C9065/C9070 Print Server more than 50% faster compared to the EX-i C9065/C9070 Print Server Print Server, making it the best choice for demanding production environments.

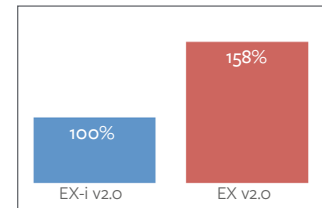

### 2. COMPLIANCE WITH KEY SECURITY STANDARDS

The EX C9065/C9070 Print Server is validated for key customer security requirements, such as FIPS 140-2 compliant data encryption (ISO/IEC 15408 & IEEE Std 2600 (Common Criteria) compliant\*). For more information, please refer to the [Fiery FS500 Pro security white paper](#).



### 3. MICROSOFT WINDOWS IOT ENTERPRISE 2019 LTSC

The EX C9065/C9070 is built on the Microsoft Windows IoT Enterprise 2019 LTSC operating system. Plus, the server offers the option to use a customer hardened Windows OS image to meet security compliance requirements.



### 4. OPTION FOR REMOVABLE DISK DRIVES

The EX C9065/C9070 offers optional Fiery disk drive security kits, which allow the disk drives to be removed and stored in a secure location. Plus, additional disk drives are available so jobs can be segregated by security condition (such as Classified, Top Secret, Secret) if needed.

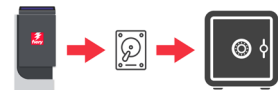

### 5. FIERY PREFLIGHT PRO

The ultimate set of PDF preflight checks, Fiery Preflight Pro (part of the optional [Fiery Graphic Arts Pro Package](#)) allows users to verify file compliance against industry standards and identify potential errors in files, which can then be viewed in the interactive Preflight Pro Report.

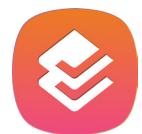

### 6. ADVANCED VDP FORMATS

The EX C9065/C9070 Print Server supports all advanced VDP formats out-of-the-box, including PDF/VT-2, Creo® VPS®, PPML, and Xerox® VIPP®. Plus, it works with all leading VDP composition software and formats for seamless workflows. The faster processing speed also makes offering VDP services more profitable.





## Xerox EX C9065/C9070 Print Server v2.0: Exclusive features (continued)

### 7. FIERY QUICKTOUCH™ SOFTWARE

Fiery external servers feature the [Fiery NX Pro hardware](#). The NX Pro includes [Fiery QuickTouch](#) software on the touchscreen display, which gives faster views of job status information and access to server management. With just a tap, the touchscreen display gives operators easy access to intuitive system installation, backup and restore, plus system diagnostics.



### 8. A CENTRALIZED PRODUCTION WORKSPACE FOR OPERATORS

The [Fiery NX Station GL](#) is a compact, centralised workstation for Fiery external servers. It features a 22" display, Fiery Ticker, work stand, and a wireless keyboard and mouse



## Xerox EX C9065/C9070 Print Server v2.0: Standard features

The Xerox EX C9065/C9070 Print Server includes these key features in the standard configuration. They are available for the EX-i C9065/C9070 Print Server by purchasing optional packages. Be sure to compare the cost of the EX-i C9065/C9070 Print Server with the optional packages added for a more accurate comparison to the EX C9065/C9070 Print Server.

### 1. FIERY JOBEXPERT

Reduce setup time and cut waste with [Fiery JobExpert™](#) — a built-in feature in Fiery Command WorkStation® — that automatically analyses each PDF print job in detail and sets the best Fiery job settings for colour management, image quality, VDP settings, and engine specific properties. Plus, Fiery JobExpert includes exclusive presets for the Xerox PrimeLink C9065/C9070 that automatically configure optimal colour & engine properties to deliver more pleasing output.



### 2. PERFECT PDF PRINTING IN A PURE PDF WORKFLOW

Adobe PDF Print Engine offers the option of a native PDF end to-end workflow. Improves the consistency and flexibility of the printed output from design to output in digital and offset print solutions.



Adobe PDF Print Engine

## Xerox EX C9065/C9070 Print Server v2.0: Standard features (continued)

### 3. FULLY VISUAL IMPOSITION

[Fiery Impose](#) enables easy booklet creation, provides several gangups, supports cutting and stacking, plus integrates with offline finishers to reduce 70% of job setup time.



### 4. BUILT-IN PREFLIGHT

Fiery Preflight provides basic preflight checks for problems in a file. Catch issues before printing such as missing elements like spot colours or fonts, or potential errors like low-resolution images or overprint. You can automate basic preflight checks through Fiery Hot Folders or integrate with Fiery JobFlow Base/JobFlow.



### 5. SUPERIOR PHOTOGRAPHIC PRINTS

[Fiery Image Enhance Visual Editor](#), a Command WorkStation plug-in, allows operators to make last-minute edits to a selected image without having to open the image in applications such as Adobe Photoshop®.



### 6. AUTOMATE REPETITIVE MANUAL JOB SETUP

With the free [Fiery JobFlow Base](#), you can start building ready-to-use workflows today. It's a browser-based solution that automates common job types to produce ready-to-print files, significantly reducing human errors in job setup to save time, increase production capacity, and meet tight deadlines.



## Both Fiery servers: Optional features

These features are available on both the Xerox EX C9065/C9070 Print Server and EX-i C9065/C9070 Print Server by purchasing optional packages.

### 1. SAVE TIME ON COMPLEX DOCUMENT PREPARATION

Add [Fiery JobMaster](#) to offer advanced PDF makeready capabilities such as insertion of tab pages without the need to design them in the native application, multi-bank and bleed-edge tab setup, page merging, media assignment, finishing, page numbering, plus hard-copy scanning and cleanup. This allows you to produce jobs completely inline and reduce labor costs on manual tab insertion.



### 2. FIERY SPOT PRO

The most advanced tool for managing spot colours, Fiery Spot Pro ensures that brand colours are reproduced correctly, every time. With Fiery Spot Pro, users get powerful new capabilities, like the ability to create a spot colour alias, import/export spot colour libraries in Adobe Swatch Exchange, create more customised swatch books, edit spot colours in L\*a\*b, edit spot colour tints, and edit spot colours in a specific job.



### 3. FIERY IMAGEVIEWER

With Fiery ImageViewer, the user can make more powerful late-state colour edits right at the DFE. Choose to edit colours in a specific area of the page, including replacing specific colour, or adjusting the colour curves. Plus, generate soft proofs for customers in just a few clicks.



### 4. ACCELERATED PRODUCTION WITH PREPRESS WORKFLOW AUTOMATION

Add [Fiery JobFlow](#) for cost-effective, advanced prepress capabilities. You can easily configure automated job workflows including PDF conversion, preflight, correction and editing of PDF files, image enhancement, document imposition, plus approval and job ticketing.





Fiery server	EX C9065/C9070 v2.0	EX-i C9065/C9070 v2.0
Fiery software	Fiery FS500 Pro	Fiery FS500
Fiery platform	NX Pro III	E500
CPU	Intel® Core™ i5-8500 Processor	Intel Core i3-8100 Processor
Operating system	Microsoft® Windows® 10 IoT Enterprise 2019 LTSC	Linux
RAM	8 GB	8 GB
Disk drive(s)	SSD boot drive for OS & Fiery software + 1 TB HDD	500 GB HDD
Fiery disk drive security kits	OPTIONAL	Not Available
VDP formats	PPML 2.0/2.2/3.0, PDF/VT-1, PDF/VT-2, VPS, VIPP, Fiery FreeForm™ Plus	Fiery FreeForm Plus PDF/VT-1 OPTIONAL with Fiery JobExpert and PDF Processing Kit
Adobe® PDF Print Engine	INCLUDED	OPTIONAL with Fiery JobExpert and PDF Processing Kit
PDF/X-4 output intent	INCLUDED	OPTIONAL with Fiery JobExpert and PDF Processing Kit
Fiery JobExpert	INCLUDED	OPTIONAL with Fiery JobExpert and PDF Processing Kit
Fiery Image Enhance Visual Editor	INCLUDED	OPTIONAL with Fiery ColorRight Package*
Fiery ImageViewer, Fiery Spot Pro, Fiery Postflight, Fiery Control Bar	OPTIONAL with Fiery Graphic Arts Pro Package*	OPTIONAL with Fiery ColorRight Package*
Fiery Preflight Pro	OPTIONAL with Fiery Graphic Arts Pro Package*	Not Available
Fiery Preflight	INCLUDED	OPTIONAL with Fiery Automation Package*
Fiery JDF	INCLUDED	INCLUDED
Fiery JobFlow Base	FREE	OPTIONAL with Fiery Automation Package*
Fiery JobFlow*	OPTIONAL	OPTIONAL with Fiery Automation Package*
Fiery Impose*	INCLUDED	OPTIONAL
Fiery Compose	INCLUDED	INCLUDED
Fiery JobMaster*	OPTIONAL	OPTIONAL
Fiery Graphic Arts Pro Package*	OPTIONAL	Not Available
Fiery JobExpert and PDF Processing Kit	All features in kit are included	OPTIONAL
Fiery ColorRight Package*	Not Available	OPTIONAL
Fiery Automation Package*	Not Available	OPTIONAL
Fiery Color Profiler Suite** w/EFI ES-3000 spectrophotometer	OPTIONAL	OPTIONAL
Fiery NX Station GL	OPTIONAL	Not Available
Fiery FreeForm Create	INCLUDED	INCLUDED
Fiery Edge factory profiles	INCLUDED	INCLUDED
Fiery Spot-On™	INCLUDED	INCLUDED
For more information on all of the features, please visit the <a href="#">Xerox PrimeLink C9065/C9070 Printer page</a> .		

- \* Free 30-day trial available
- \*\* Free trial in demo mode available



EFI™ is a global technology company, leading the worldwide transformation from analog to digital imaging. We are passionate about driving customers' business growth with a scalable portfolio of products, solutions, services, and world-class partnerships for the manufacturing of signage, packaging, textiles, ceramic tiles, building materials, commercial print, and personalized documents with a wide range of printers, inks, digital front ends, and workflow software. They work together to increase profits, cut costs, improve productivity, and optimize efficiency – job after job, year after year. Learn more at [www.efi.com](http://www.efi.com).



Nothing herein should be construed as a warranty in addition to the express warranty statement provided with EFI products and services.

ColorGuard, ColorRight, Command WorkStation, ColorWise, EFI, the EFI logo, Electronics For Imaging, EFI Fiery, Fiery, the Fiery logo, Fiery Compose, Fiery Driven, the Fiery Driven logo, Fiery Edge, Fiery Essential, Fiery HyperRIP, Fiery Impose, Fiery Impress, Fiery ImageViewer, Fiery Intensify, Fiery JobExpert, Fiery JobFlow, Fiery JobMaster, Fiery Prep-it, Fiery Prints, the Fiery Prints logo, Fiery TrueBrand, FreeForm, MicroPress, IQ, PrintMe, RIPChips, RIP-While-Print, Spot-On, Spot Pro, and WebTools are trademarks or registered trademarks of Electronics For Imaging, Inc. and/or its wholly owned subsidiaries in the U.S. and/or certain other countries. All other terms and product names may be trademarks or registered trademarks of their respective owners and are hereby acknowledged.